



JM Vibro with AI

JM Vibro with AI is an innovative vibration sensor with an unique built-in intelligence. The intelligence lies in the ability to accurately detect and measure low range frequencies in low speed applications. JM Vibro with AI has been designed to monitor specific industrial applications. Both velocity and acceleration can be measured as per the specific application requirement.

Built-in intelligence

- Error output as switching output if vibration value remains steady for certain time
- Low frequency range to monitor structural and foundation vibrations
- Additional shock output fixed at 1G to register shock vibrations more than 1G in addition to bearing damage monitoring in mG acceleration
- Offers raw vibration signal to make it AI ready vibration sensor

Value to the User

- Can also operate a simple relay as a limit value (or) error output
- Built-in switching output
- Compact robust housing saving space for mounting
- Operates without an external amplifier saving additional cabling costs
- Easy selection of types as per application requirement saving user selection time

Applications



Motor

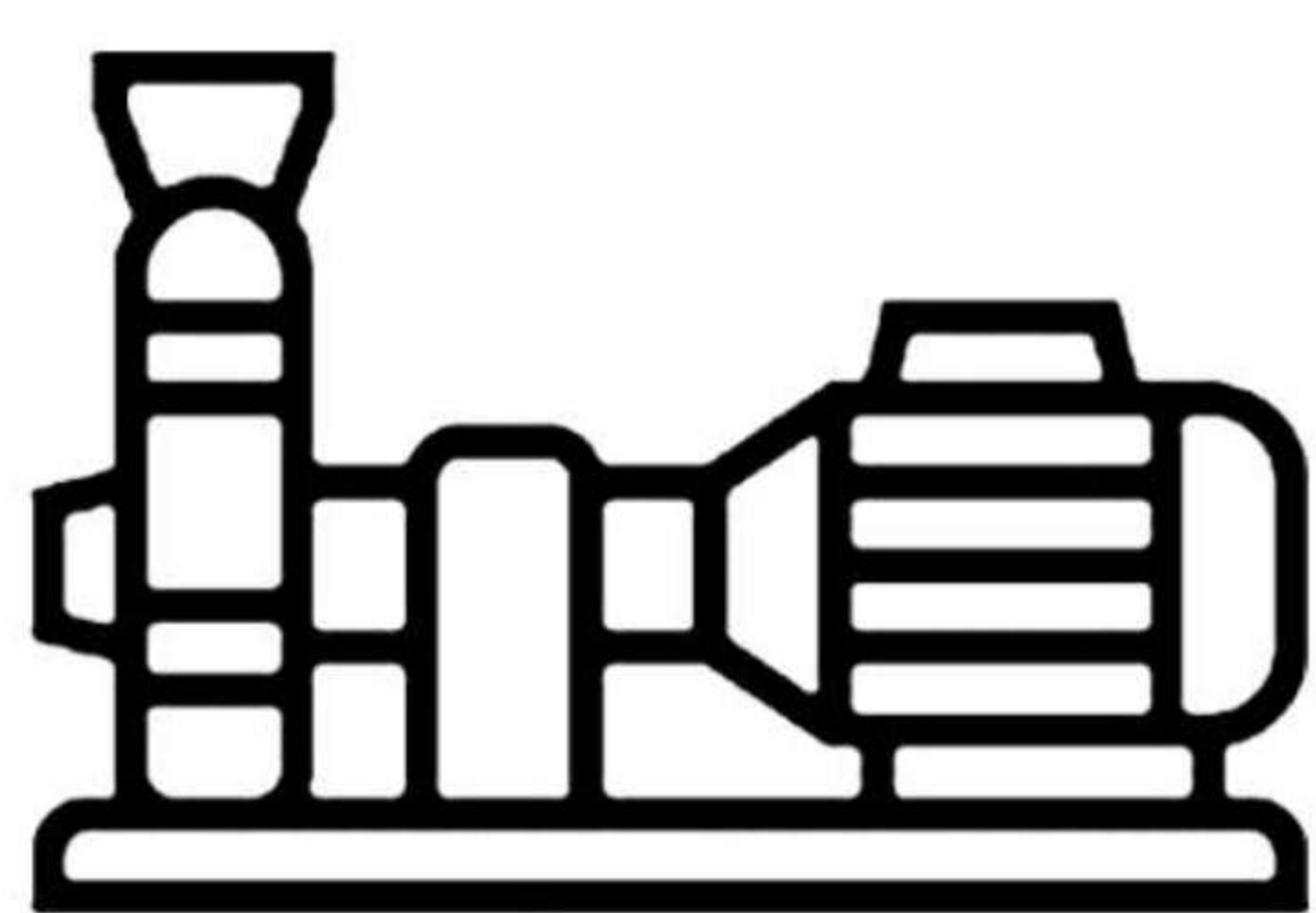

Pump

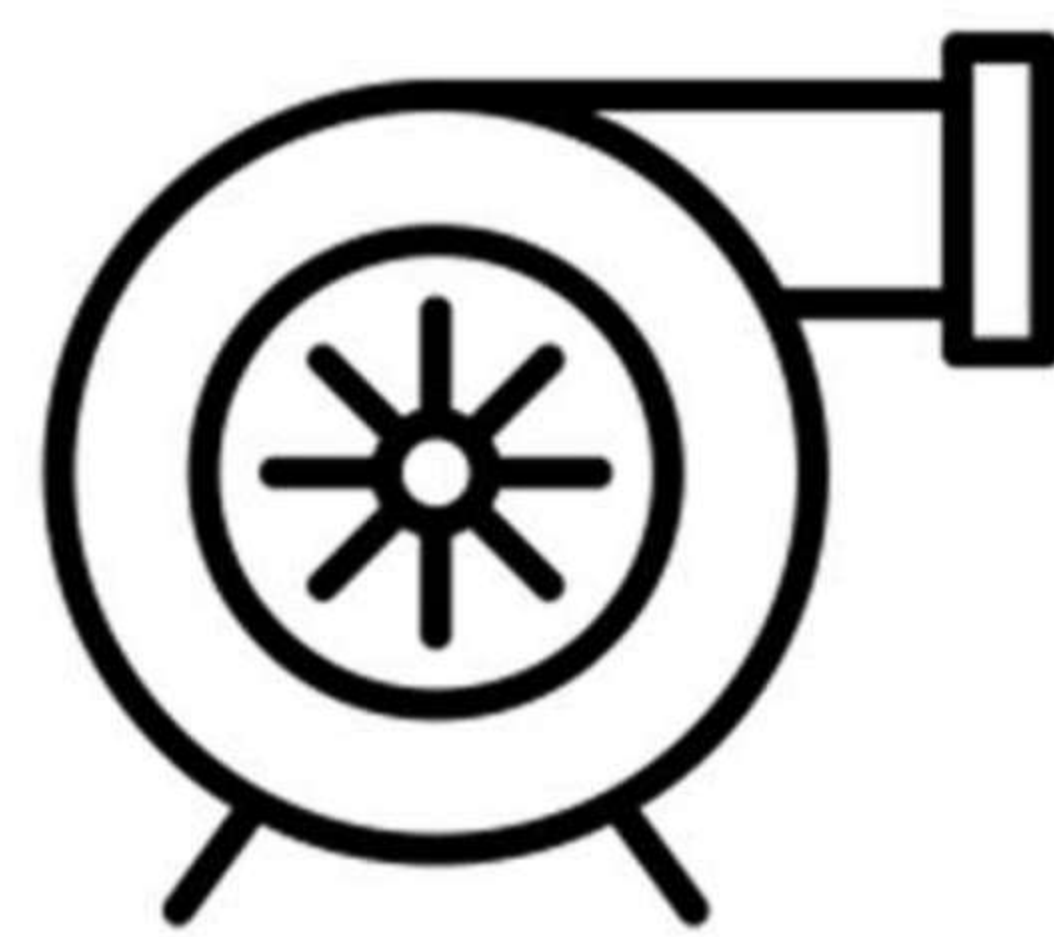

Blower



Conveyor Belt

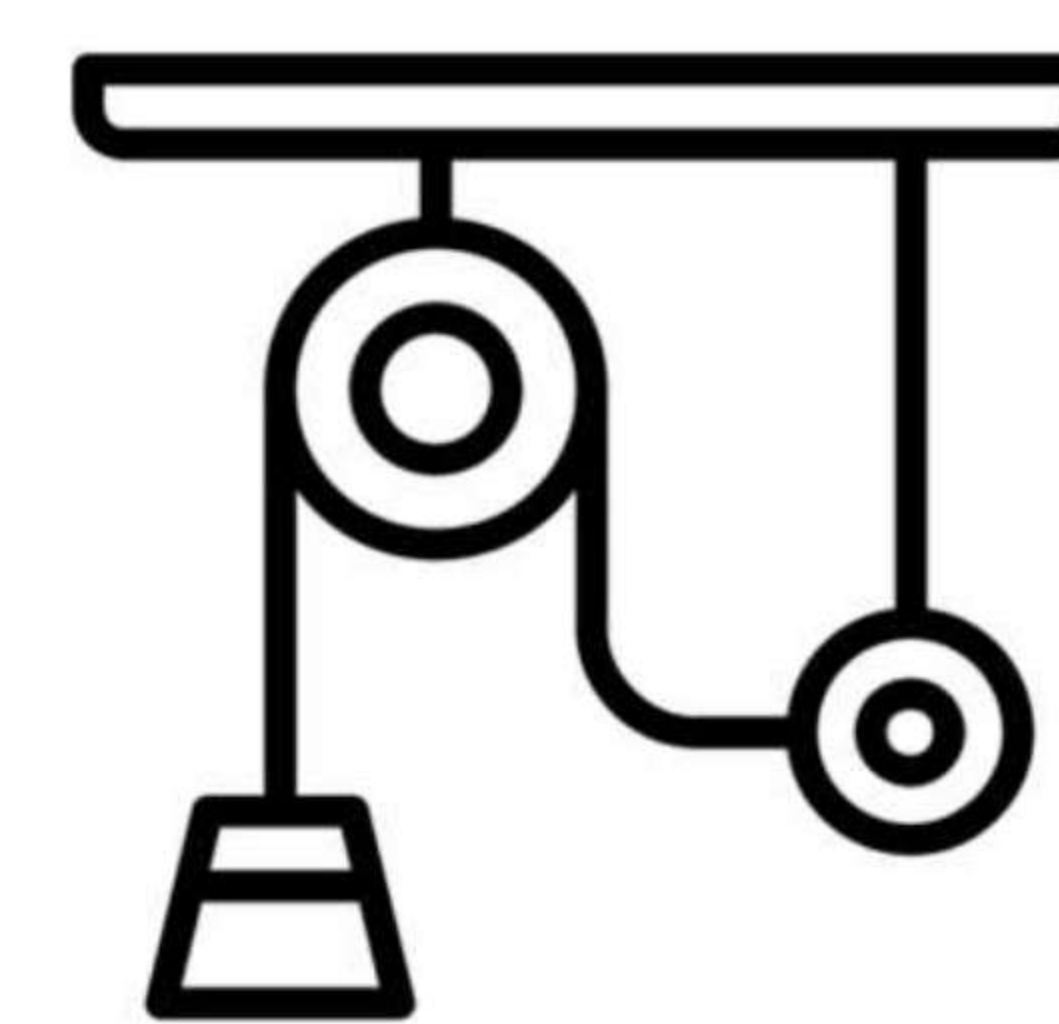

Industrial Pulley

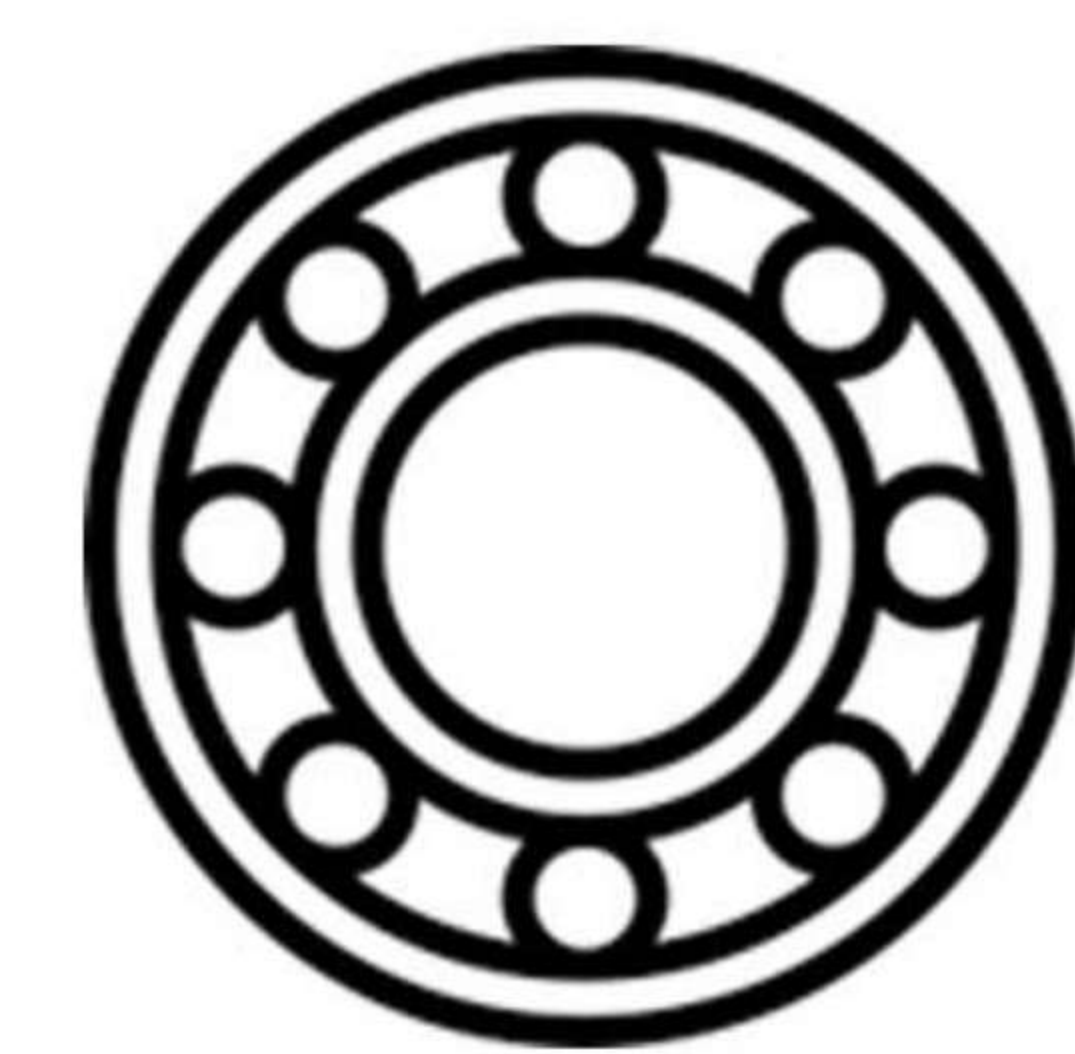

Bearing



Technical Specifications

Type Code	DV11P	DV13P	DV18S
Vibration monitoring of	Low speed rotating machinery, large pulleys, drums, slowly rotating plummer, block bearings; rotating up to 360 rpm	Spindle bearings, motor/gear box bearings, high speed rotating machines up to 10000 rpm	Imbalance, blowers, fans, pumps, rotating compressors, general vibrations up to 10000 rpm
Mounding Hole/Accessory	M8x1.25, 10 deep, M8 stud 20mm long	M8x1.25, 10 deep, M8 stud 20mm long	M8x1.25, 10 deep, M8 stud 20mm long
Frequency Range	0-10 Hz	0-1.6 KHz	0-1.6 KHz
Parameter Monitored	Velocity RMS	Acceleration RMS	Velocity RMS
Output 1 Function	Error Output ON if Analogue value remains stable within 1% for more than 3 Sec continuously	Acceleration Limit voltage Output ON at set Limit value 1000 mG	-Not Used-
Output 1 Switching	PNP, NO, 100 mA	PNP, NO, 100 mA	-Not Used-
Output 2 Parameter Range**	0-2.5 mm/Sec	0-500 mG	0-25 mm/sec
Output 2 Analogue	4-20 mA(500 Ohm max)	4-20 mA(500 Ohm max)	4-20 mA(500 Ohm max)
Operating Voltage (V DC)	20-30		
Current Consumption (mA)	50		
Protection Class	III		
Reverse Polarity/short circuit Protection	Yes		
Operating Temperature(°C)	0-60 (32°F-140°F)		
Housing Material	Stainless Steel		
Electrical Connection	5 m Long, 4 Core cable (Brown to +24VDC; Blue 0 VDC, Black Output1, White Output2)		
Protection Class	IP65		
Dim. D1/H1/H2/HEX D2 mm	32 / 87 / 10 / 34	32 / 87 / 10 / 34	24 / 72 / 10 / 26

**Special types For Other Parameter Ranges available on request

J-VB
SERIES

Intelligent AI Vibration Sensing

JM-Vibro Dimensions

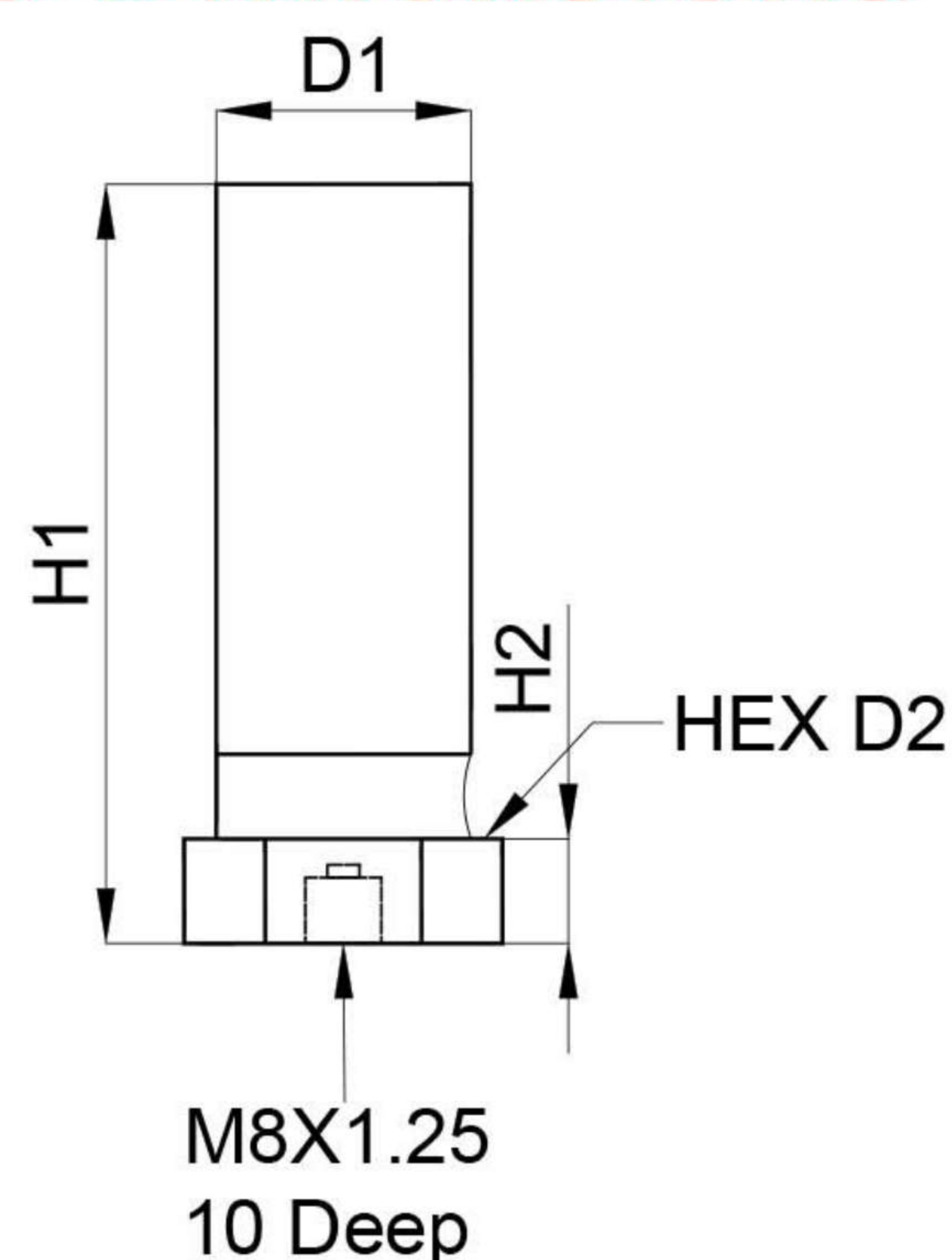

Connection Diagram

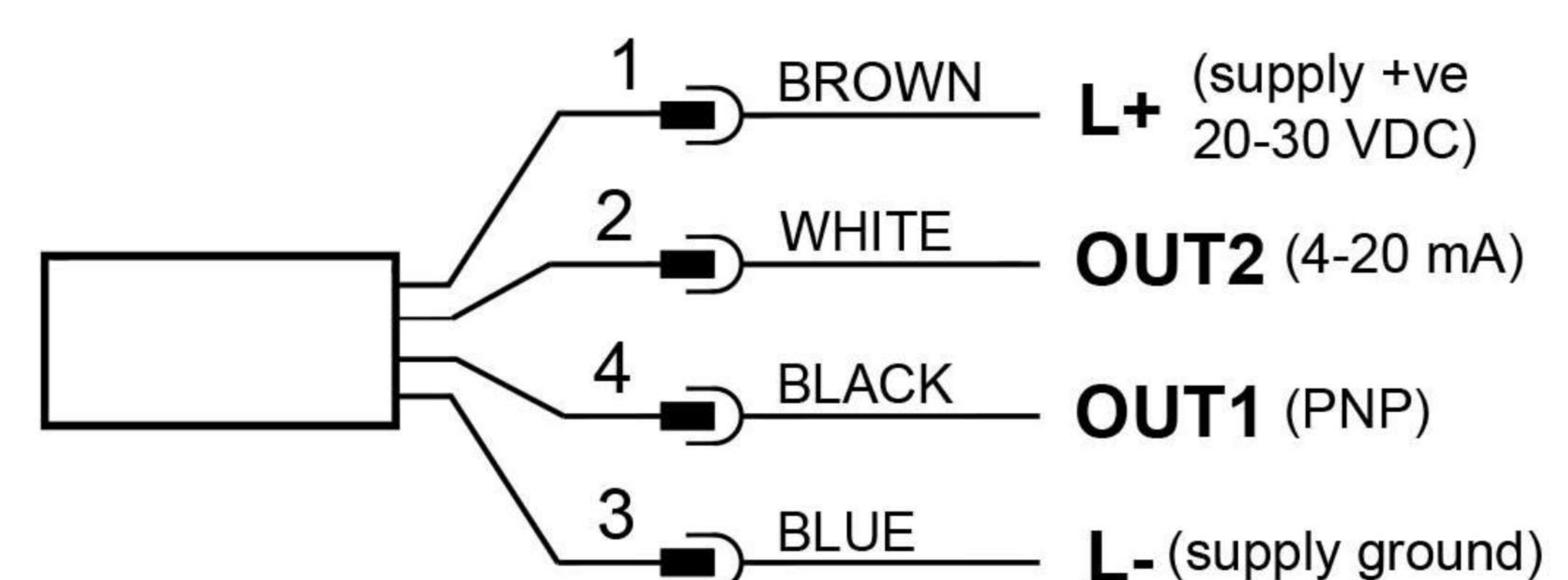

www.jmechatronic.com
info@jmechatronic.com

J Mechatronic

E-12, Keshar Kasturi, Nagala Park, Kolhapur - 416003(MH)
Republic Of India(IN)

+91 9322324103
+91 231 2667823

CE Certified